

CLEANING A BEDSIDE TABLE

The bedside table is the second most contaminated site in a patient's room. Patients and visitors regularly use it, Healthcare workers frequently move it and many personal items are placed here. Particular attention should be paid to the edges of the table and the height adjustment lever that are touched most often.

1/6

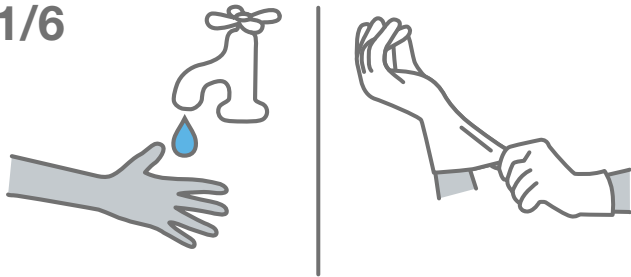

Perform hand hygiene. Wear appropriate PPE.

2/6

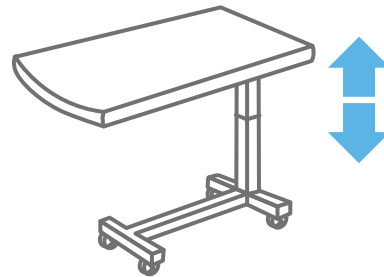

Position to correct level to prevent back injury.

3/6

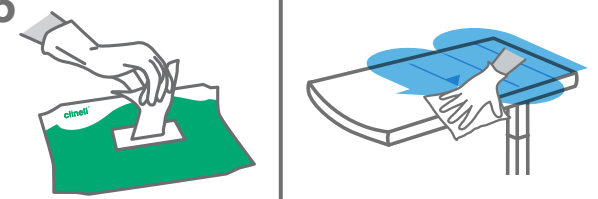

Remove one wipe from Universal pack. Wipe from top to bottom, clean to dirty in a 'S' motion. Clean underside and adjustment lever.

4/6

1. TOP SURFACE
AND EDGE OF TABLE

2. UNDERSIDE

3. FRAME

4. WHEELS

Clean in the above order.

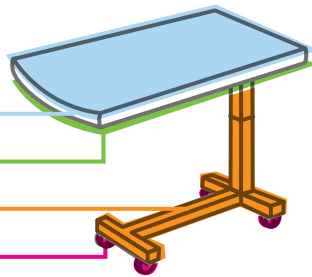

5/6

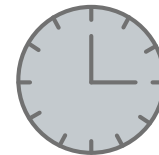
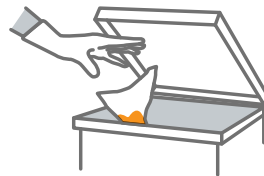

Change wipe if it is dry or soiled and discard. Allow surfaces cleaned with Universal wipes to air dry.

6/6

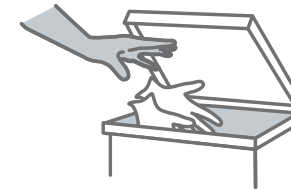

Remove all PPE and discard as per local policy. Perform hand hygiene.

© 2020 GAMA Healthcare. All rights reserved. No extract may be reproduced, stored or transmitted in any form or by any means without prior written permission.

Please ensure that you follow the equipment manufacturer's guidelines.

GH-200367