

Accessories for Genelec loudspeakers



GENELEC®

Genelec loudspeakers with compatible accessories

PRO | Classic Studio Monitors



PRO | The Ones and other SAM™ Monitors



Installed Sound | Smart IP Loudspeakers and Subwoofers



Installed Sound | 4000 Series Loudspeakers



Home Audio | G Series Loudspeakers



Contents

| | |
|---------------------------|-------|
| Table stands | 4–7 |
| Floor stands | 8–11 |
| Stand plates and Iso-Pods | 12–17 |
| Ceiling mounts | 18–23 |
| Wall mounts | 24–28 |
| Other accessories | 29–33 |
| Carrying accessories | 34–38 |



Table stands

GENELEC®

Short table stand

8000-406 Short table stand (17 cm)

Short table stand providing a raised position for loudspeakers. Improves acoustical performance by raising the loudspeaker above the table level, resulting in less reflections from the table surface. Includes heavy black cast iron base with an anti-vibration rubber ring. The tube-top mounting has a 3/8" thread. Use with stand plate and Iso-Pod for improved loudspeaker orientation.

Width (circle) 180 mm, height 170 mm. Weight 2.62 kg.

Available in black colour.

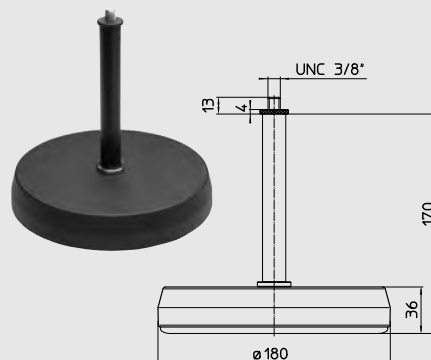

Compatible with models: 8010, 8020, 8030, 8320, 8330
G One, G Two, G Three
4010, 4020, 4030, 4410, 4420, 4430

Compatible only when using 8040-408/438 stand plate: 8040, 8340
G Four
4040 (requires stand plate and Iso-Pod kit 8040-440)

Not to be used with 8331.

Adjustable-height table stand

8000-425B Adjustable-height table stand (301-527 mm)

Adjustable-height table stand with a base plate that can be attached to a table or flat surface. Increases acoustical performance by raising the loudspeaker above the table level, which results in less reflections from the table surface. Use with stand plate and Iso-Pod for improved loudspeaker orientation. Screws and fixing nuts for a 40 mm thick table are included.

Width (circle) 104 mm, height 301-527 mm. Weight 0.73 kg.

Available in black colour.

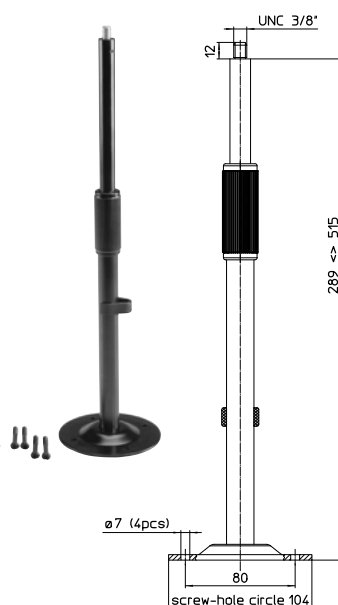

Compatible with models: 8010, 8020, 8030, 8320, 8330, 8331
G One, G Two, G Three
4010, 4020, 4030, 4410, 4420, 4430

Compatible only when using 8040-408/438 stand plate: 8040, 8340
G Four
4040 (requires stand plate and Iso-Pod kit 8040-440)

L-shape table stand for XX10 & G One

8010-320B Table stand L-shape for XX10, black

8010-330W Table stand L-shape for XX10, white

L-shape table stand for vertical mounting of loudspeakers. Improves acoustical performance by raising the loudspeaker above the table level, resulting in less reflections from the table surface – while enabling the loudspeaker to be aimed correctly at the listening position. The sturdy stand has a 0-20 degree upward tilt angle adjustment.

Width 110 mm, height 211 mm, depth 124 mm. Weight 0.72 kg.

Available in black and white colours.



Compatible with models: 8010
G One
4010, 4410



L-shape table stand for XX20 & G Two

8020-320B Table stand L-shape for XX20, black

8020-330W Table stand L-shape for XX20, white

L-shape table stand for vertical mounting. Easily positions the loudspeaker on a table, with the ability to aim it towards the listening position. The stand improves acoustical performance by raising the loudspeaker above the table level, resulting in less reflections from the table surface. Features a 0-20 degree upward tilt angle adjustment.

Width 136 mm, height 256 mm, depth 153 mm. Weight 1.07 kg.

Available in black and white colours.



Compatible with models: 8020, 8320
G Two
4020, 4420



L-shape table stands for XX3X & G Three

8000-333B Table stand L-shape for XX3X, black

8000-333W Table stand L-shape for XX3X, white

L-shape table stand for vertical and horizontal mounting. Easily positions the loudspeaker on a table, with the ability to aim it towards the listening position. The stand improves acoustical performance by raising the loudspeaker above the table level, resulting in less reflections from the table surface. Features a 0-20 degree upward tilt angle adjustment.

Width 180mm, height 335mm, depth 190mm. Weight 2.62 kg.

Available in black and white colours.



Compatible with models: 8030, 8330, 8331
G Three
4030, 4430

L-shape table stand for XX4X/XX5X, G Four & G Five

8000-325B Table stand L-shape for XX4X/XX5X, black

8000-335W Table stand L-shape for XX4X/XX5X, white

L-shape table stand for vertical and horizontal mounting. Easily positions the loudspeaker on a table, with the ability to aim it towards the listening position. The stand improves acoustical performance by raising the loudspeaker above the table level, resulting in less reflections from the table surface. Features a 0-20 degree upward tilt angle adjustment.

Width 300 mm, height 403 mm, depth 300 mm. Weight 5.29 kg.

Available in black and white colours.



Compatible with models: 8040, 8340, 8341, 8050, 8350, 8351
G Four, G Five
4040



Floor stands

GENELEC®

Small floor stand

8000-403 Floor stand (mic stand)

Floor stand featuring a cast iron base with an anti-vibration rubber ring. Easily raises the loudspeaker to the desired off-floor position. The stand's height is adjustable from 870 to 1565 mm, and base diameter is 250 mm. It is recommended to use this floor stand with a separately available, model-specific stand plate that's designed to fit the loudspeaker's Iso-Pod. For 4000 and 4400 series installation speakers, Iso-Pods are available separately.

Weight 5.52 kg.

Available in black colour.

Compatible with models: 8010, 8020, 8030, 8320, 8330
G One, G Two, G Three
4010, 4020, 4030
4410, 4420, 4430

Not to be used with 8331.

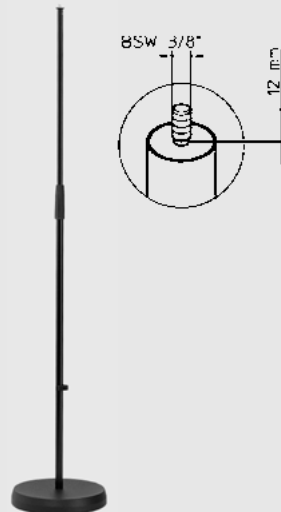

Floor stand

8000-409BB Floor stand (950-1430 mm), black

8000-409BW Floor stand (950-1430 mm), white

Solid steel stand allowing you to adjust the monitor height quickly between 950-1430 mm using a clamping screw and safety pin. Easily raises the loudspeaker to the desired off-floor position. The stand's broad round cast iron base (Ø 450 mm) supports up to 35 kg. Comes in two cardboard packages; the base in the first and stand in the second, and cannot be used without separately available, modelspecific stand plates designed to fit the loudspeaker's Iso-Pod. For 4000 and 4400 series installation speakers, Iso-Pods are available separately.

Weight 9.10 kg.

Available in black and white colours.

Compatible with models: 8000 and 8300 models (except 8361)
G series loudspeakers
4000 and 4400 series (except 4435/36)

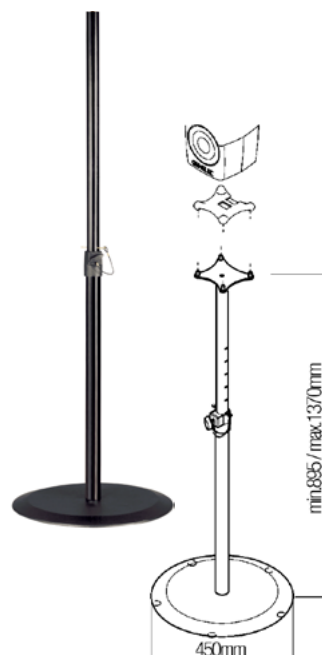

Floor stand for S360, 8x5x, 8x6x & G Five

S360-415B Floor stand for S360 and 8XXX

Floor stand with adjustable height for larger loudspeakers. Easily raises a larger loudspeaker to the desired off-floor position. Height is adjustable in 50 mm steps between 650-1050 mm. Requires separately available, model-specific stand plate to go in between the stand and the loudspeaker.

Width 500 mm, length min/max 650-1050 mm, depth 500 mm.

Weight 16.75 kg.

Available in black colour.



Compatible when using 8051-408 or 8051-438 stand plate: 8050, 8350, 8351 G Five

Compatible when using 8260-450B stand plate: 8361

Compatible when using S360-408B stand plate or with S360-450B side-side mounting bracket: S360

Genelec design floor stand

8000-400B Genelec design stand, black

8000-400W Genelec design stand, white

Floor stand conceptualised by Award-winning industrial designer and 8000 Series design collaborator, Harri Koskinen, and created in close co-operation with iconic audio accessory manufacturer, K&M. Elegantly raises the loudspeaker to the desired off-floor position. Combines a 420 x 420 mm cast iron base with an oversized shaft, making it supremely stable. Gradual height adjustment between 1100-1700 mm is made simple by a sturdy positioning and clamping knob. Quick and easy vertical mounting of the loudspeaker is accomplished using the suspension device. For horizontal mounting, an additional adapter (8000-438) is required.

Weight 14.50 kg.

Available in black and white colours.



Compatible with models: 8030, 8330, 8331, 8040, 8340, 8341, 8050, 8350, 8351 G Three, G Four, G Five 4030, 4430, 4040

Triol stand

8000-450B Triol Speaker stand, black

8000-450W Triol Speaker stand, white

Elegant three-legged floor stand designed in collaboration with award-winning Industrial Designer Harri Koskinen, combining practicality with minimalist Nordic flair. Effortlessly raises the loudspeaker towards the listening height. After a simple assembly, all that is required is to screw on the separately available, model-specific stand plate, which fits snugly into the IsoPod under the loudspeaker. Cables conveniently tidy away in channels and are secured using neat magnetic holders. For 4000 and 4400 series installation speakers, Iso-Pods are available separately.

Width (circle) 428mm, height 700mm. Weight 19 kg, iron, powder coating.

Available in black and white colours.

Compatible with models: 8020, 8030, 8040, 8320, 8330, 8340
G Two, G Three, G Four
4020, 4030, 4040, 4420, 4430





Stand plates and Iso-Pods

GENELEC®

Stand plate for XX10 & G One Iso-Pod

8010-408B Stand plate for XX10 Iso-Pod, black
8010-438W Stand plate for XX10 Iso-Pod, white

Stand plates designed to be used in combination with the Iso-Pod of 8010, G One, 4010 or 4410 loudspeakers. Iso-Pods allow vertical tilting of the loudspeaker for optimal alignment. The stand plate mounts onto the standard 3/8" thread commonly used on mic stands. The four pins of the stand plate securely hold the Iso-Pod and loudspeaker in place.

Width 130 mm, height 120 mm, depth 25 mm. Weight 0.25 kg.

Available in black and white colours.



Stand plate and Iso-Pod assembly.

Compatible with models: 8010
G One

Compatible if an Iso-Pod is used: 4010, 4410

Stand plate for XX20 & G Two Iso-Pod

8020-408B Stand plate for 8020 Iso-Pod, black
8020-438W Stand plate for 8020 Iso-Pod, white

Stand plates designed to be used in combination with the Iso-Pod of 8020, 8320, G Two, 4020 and 4420 loudspeakers. Iso-Pods allow vertical tilting of the loudspeaker for optimal alignment. The stand plate mounts onto the standard 3/8" thread commonly used on mic stands. The four pins of the stand plate securely hold the Iso-Pod and loudspeaker in place.

Width 114 mm, height 24 mm, depth 108 mm. Weight 0.45 kg.

Available in black and white colours.



Stand plate and Iso-Pod assembly.

Compatible with models: 8020, 8320
G Two

Compatible if an Iso-Pod is used: 4020, 4420

Stand plate for XX3X & G Three

| | |
|------------------|---|
| 8030-408B | Stand plate for 8X30, 8331 Iso-Pod, black |
| 8030-438W | Stand plate for 8x30, 8331 Iso-Pod, white |

Stand plates designed to be used in combination with the Iso-Pod of 8030, 8330, 8330, G Three, 4030 and 4430 loudspeakers. Iso-Pods allow vertical tilting of the loudspeaker for optimal alignment. The stand plate mounts onto the standard 3/8" thread commonly used on mic stands. The four pins of the stand plate securely hold the Iso-Pod and loudspeaker in place.

Width 126 mm, height 24 mm, depth 110 mm. Weight 0.5 kg.

Available in black and white colours.



Stand plate and Iso-Pod assembly.

Compatible with models: 8030, 8330, 8331
G Three

Compatible if an Iso-Pod is used: 4030, 4430

Stand plate for XX4X & G Four

| | |
|------------------|---|
| 8040-408B | Stand plate for 8X40, 8341 Iso-Pod, black |
| 8040-438W | Stand plate for 8x40, 8341 Iso-Pod, white |

Stand plates designed to be used in combination with the Iso-Pod of 8040, 8341, G Four, 4040 loudspeakers. Iso-Pods allow vertical tilting of the loudspeaker for optimal alignment. The stand plate mounts onto the standard 3/8" thread commonly used on mic stands. The four pins of the stand plate securely hold the Iso-Pod and loudspeaker in place.

Width 156 mm, height 26,5 mm, depth 136 mm. Weight 0.76 kg.

Available in black and white colours.



Stand plate and Iso-Pod assembly.

Compatible with models: 8040, 8340, 8341
G Four

Compatible if an Iso-Pod is used: 4040

Stand plate for XX5X & G Five

8051-408B Stand plate for 8X50, 8351 Iso-Pod, black
8051-438W Stand plate for 8x50, 8351 Iso-Pod, white

Stand plates designed to be used in combination with the IsoPod of 8050, 8351, and G Five loudspeakers. IsoPods allow vertical tilting of the loudspeaker for optimal alignment.

The stand plate mounts onto the standard 3/8" thread commonly used on mic stands. The four pins of the stand plate securely hold the IsoPod and loudspeaker in place.

Width 195 mm, height 30 mm, depth 170 mm. Weight 1.1 kg.

Available in black and white colours.



Stand plate and Iso-Pod assembly.

Compatible with models: 8050, 8350, 8351
G Five

Stand plate for 8361

8260-450B Stand plate for 8361 Iso-Pod, black

Stand plates designed to be used in combination with the Iso-Pod of 8361 loudspeaker. Iso-Pods allow vertical tilting of the loudspeaker for optimal alignment. The stand plate mounts onto the standard 3/8" thread commonly used on mic stands. The four pins of the stand plate securely hold the Iso-Pod and loudspeaker in place.

Weight 2.92 kg.

Available in black colours.



Stand plate and Iso-Pod assembly.

Compatible with models: 8361

Stand plate for S360

S360-408B Stand plate for S360

Stand plate to be used with Genelec Floor Stand S360-415B for the S360. Provides a stable platform to hold the loudspeaker on top of the stand. Includes mounting screws to secure to the Iso-Plate of the S360.

Weight 5.7 kg.

Available in black colour.

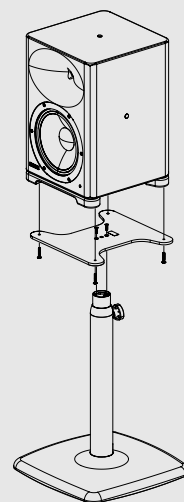

Compatible with models: S360

Stand plate for 1032

1032-450B Stand plate for 1032

To be mounted on a stable floor stand, for example on the 8000-409B. Attaches to stands using a standard 3/8" thread, which are commonly found on mic stands. Allows a 15-degree tilt, and a rear press-fit bar keeps the enclosure securely fixed onto the plate.

Weight 2.41 kg.

Available in black colour.

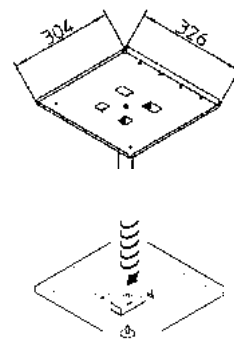

Compatible with models: 1032

Horizontal mounting adapter for design floor stand

8000-438 Adapter for horizontal mounting, black

Mounting adapter for Genelec Design Floor Stand (8000-400) allowing horizontal orientation of the loudspeaker. Easily and securely mount the loudspeaker on its side using our elegant floor stand, which we created in collaboration with celebrated Industrial Designer Harri Koskinen.

Weight 0.28 kg.

Available in black colour.

Compatible with models: 8040, 8340, 8050, 8350
8341, 8351
G Four, G Five

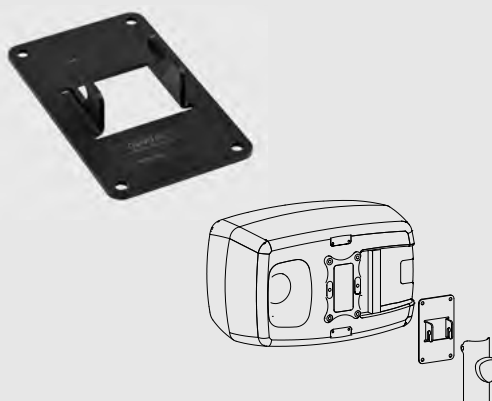

Iso-Pods

Genelec IsoPod™ kits. This kit is needed if the original one is for example lost. Bracket and screws are included.

Available in black and white colours.



XX10 & G One

6010-440 Iso-Pod and spring for XX10 & G One, black
6010-440W Iso-Pod and spring for XX10 & G One, white

Width 98,4 mm, height 21,2 mm, depth 93,6 mm

XX20 & G Two

8020-440 Iso-Pod and spring for XX20 & G Two, black
8020-440W Iso-Pod and spring for XX20 & G Two, white

Width 123 mm, height 26,5 mm, depth 117 mm

XX30 & G Three

8030-440 Iso-Pod and spring for XX30 & G Three, black
8030-440W Iso-Pod and spring for XX30 & G Three, white

Width 136 mm, height 26,5 mm, depth 119,8 mm

XX40 & G Four

8040-440 Iso-Pod and spring for XX40 & G Four, black
8040-440W Iso-Pod and spring for XX40 & G Four, white

Width 166 mm, height 29 mm, depth 146 mm

XX50 & G Five

8050-440 Iso-Pod and spring for XX50 & G Five, black
8050-440W Iso-Pod and spring for XX50 & G Five, white

Width 207,5 mm, height 36,2 mm, depth 182,5 mm

8331

8331-440 Iso-Pod and spring for 8331, black
8331-440W Iso-Pod and spring for 8331, white

Width 136 mm, height 32,5 mm, depth 119,8 mm

8341

8341-440 Iso-Pod and spring for 8341, black
8341-440W Iso-Pod and spring for 8341, white

Width 156 mm, height 32,5 mm, depth 136 mm

8351

8351B-440 Iso-Pod and spring for 8351, black
8351B-440W Iso-Pod and spring for 8351, white

Width 328 mm, height 543 mm, depth 298 mm

8361 for vertical mounting

8361A-440V Iso-Pod and spring for 8361, black
8361A-440WV Iso-Pod and spring for 8361, white

Width 400 mm, height 400 mm, depth 100 mm

8361 for horizontal mounting

8361A-440H Iso-Pod and spring for 8361, black
8361-440WH Iso-Pod and spring for 8361, white

Width 400 mm, height 400 mm, depth 100 mm



Ceiling mounts

GENELEC®

Short ball joint ceiling mount

8000-202B Short ceiling mount ball joint, black
8000-202W Short ceiling mount ball joint, white

Short, versatile ceiling mount with a ball joint enabling 360-degree rotation and up to 90 degrees of tilt. Easily mount the loudspeaker on a ceiling and orient it. Amount of tilt available varies slightly depending on the mounted loudspeaker.

Width 95 mm, height 95 mm, depth 158,5 mm. Weight 0.62 kg.

Available in black and white colours.

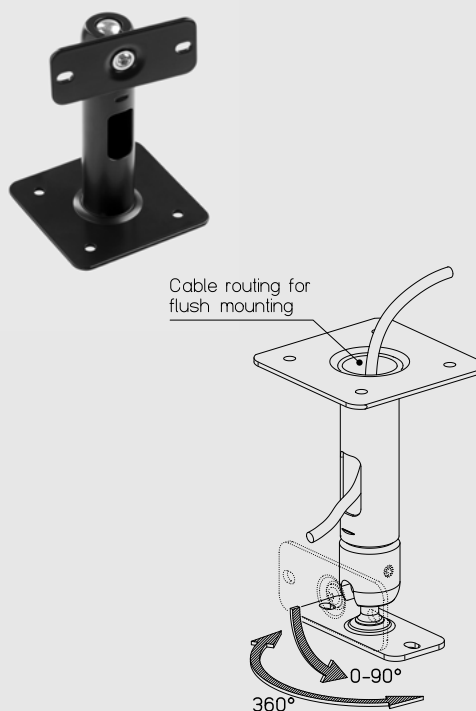

Compatible with models: 8010, 8020, 8320
 G One, G Two
 4010, 4020
 4410, 4420

Short ceiling mount

8000-436B Short ceiling mount, black
8000-436W Short ceiling mount, white

Short ceiling mount for all 8000, 4000 and G Series models. Easily mount the loudspeaker on a ceiling and orient it with both vertical and horizontal tilting. Sturdy and reliable design provides solid support.

Width 126 mm, length 295 mm, depth 160 mm. Weight 1.97 kg.

Available in black and white colours.

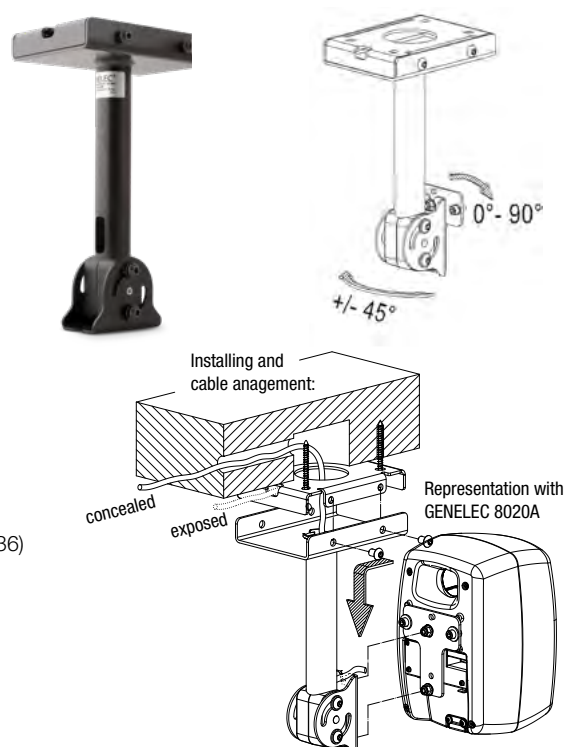

Compatible with models: 8000 and 8300 Series,
 G Series
 4000 and 4400 Series (excluding 4435/36)

Compatible only when using 8000-454 T-adaptor plate: 8320, 8330, and 8331

Not to be used with 8361.

Short adjustable ceiling mount

8000-442B Short ceiling mount, black
8000-442W Short ceiling mount, white

The adjustable ceiling mount is suitable for all 8000, 4000 and G series models. The mounting system has three different height positions, at 400, 500 and 600 mm, and a down-tilt feature of up to 90 degrees. A hollow circular tube with an inside diameter of 50 mm allows you to hide cables by running them through the tube. A separate 8000-454 T-adapter plate is required with the models 8320, 8330 and 8331.

Width 126 mm, length min. 445 mm, depth 160 mm. Weight 2.74 kg.

Available in black and white colours.

Compatible with models: 8000 and 8300 Series (excluding 8361)
 G Series
 4000 and 4400 Series (excluding 4435/36)

Compatible only when using 8000-454 T-adapter plate: 8320, 8330, and 8331

Compatible when using S360-424 Top-Bottom and S360-450 Side-Side Brackets: S360

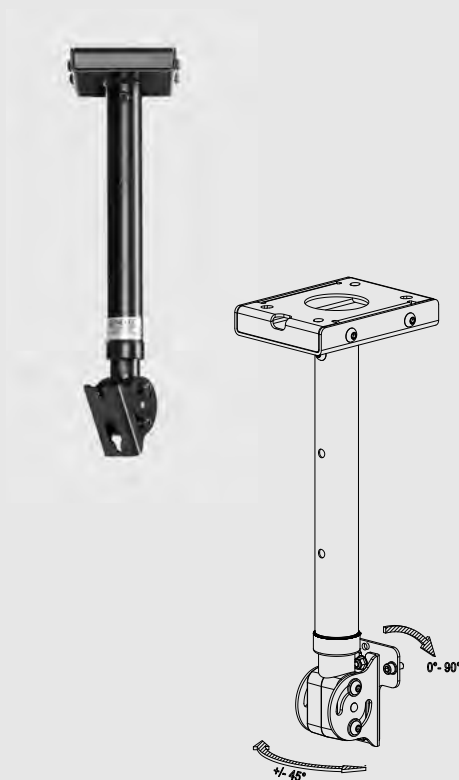

Long adjustable ceiling mount

8000-444B Long adjustable ceiling mount, black
8000-444W Long adjustable ceiling mount, white

Long ceiling mount that adjusts easily to the desired length. Features six different heights: 700, 800, 900, 1000, 1100 and 1200 mm, and a down-tilt feature of up to 90 degrees. A hollow tube with an inside diameter of 50 mm neatly hides cables.

Width 126 mm, length 744,75 mm, depth 160 mm. Weight 5.3 kg.

Available in black and white colours.

Compatible with models: 8000 and 8300 Series (excluding 8361)
 G Series
 4000 and 4400 Series (excluding 4435/36)

Compatible only when using 8000-454 T-adapter plate: 8320, 8330, and 8331

Compatible only when using S360-424 Top-Bottom and S360-450 Side-Side Brackets: S360

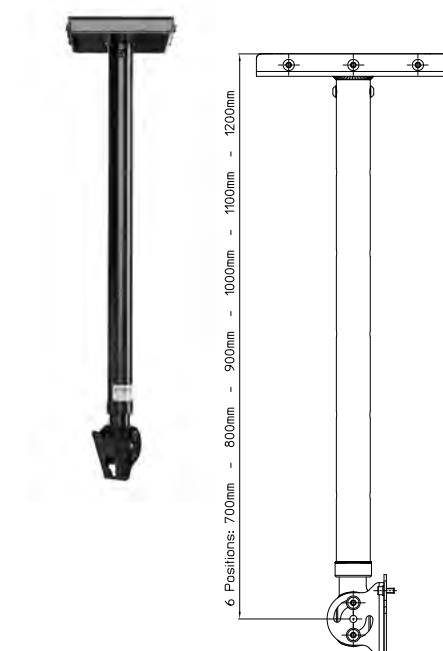

Truss mount kit with adjustable length

8000-446C Truss mount kit, adjustable length, black

Flexible-to-use truss mount that adjusts easily to the desired length. The quick length adjustment feature with three different positioning options, at 355mm, 430mm, and 505mm, makes positioning easy. The kit includes a clamp for a Ø50 mm truss tube.

Width 100 mm, length min. / max. 355-430-505 mm, depth 74 mm. Weight 2.28 kg.

Available in black colour.

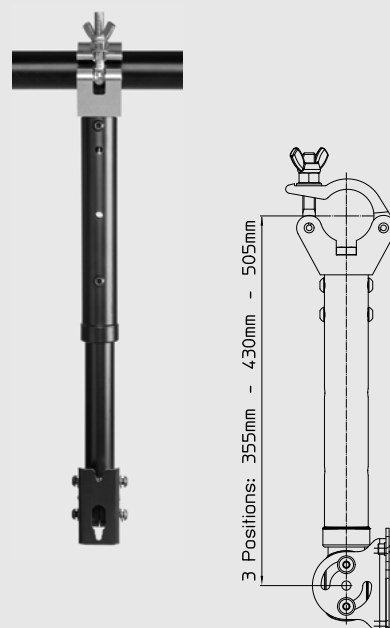

Compatible with models: 8000 and 8300 Series (excluding 8361)
G Series
4000 and 4400 Series (excluding 4435/36)

Compatible only when using 8000-454 T-adapter plate: 8320, 8330, and 8331

Short truss mount with clamp

8000-416C Short truss mount with clamp

Simple and sturdy short truss mount with a clamp for a Ø 50 mm tube. Easily mount the loudspeaker on a truss bar at the desired vertical angle and adjust the horizontal angle using the tilting feature.

Width 90 mm, height 160 mm, depth 111 mm. Weight 10.2 kg.

Available in black colour.

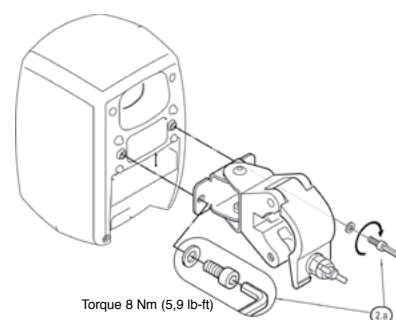

Compatible with models: 8000 and 8300 Series
G Series
4000 and 4400 Series (excluding 4435/36)

T-adapter plate for 8320, 8330 & 8331

8000-454B T-adapter plate

T-adapter Plate for installation with 8000-436, -442, -444, and -446 ceiling mounts and 8000-402 wall mount. Compatible with Genelec 8320, 8330 and 8331 loudspeaker monitors.

Width 90mm, height 87mm, depth 25mm. Weight 0.19 kg.

Available in black colour.

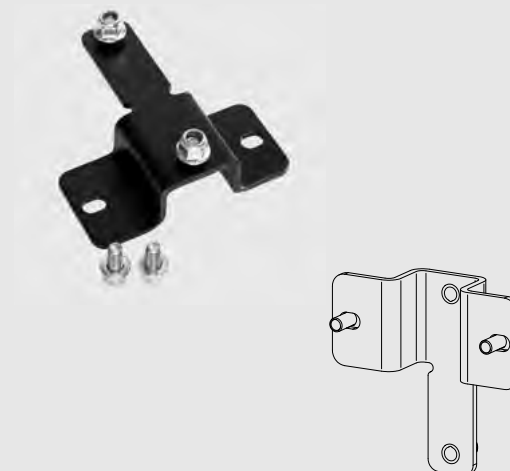

Compatible with models: 8320, 8330, and 8331

Ceiling mount plate for S360 brackets

S360-465B Ceiling mount plate for S360 brackets

Adjustable ceiling mount plate for S360, requiring separate S360-450B Side-Side Mounting Bracket or S360-424B Top-Bottom Mounting Bracket, which enables easy tilting and aiming of the loudspeaker towards the desired listening position.

Width 220 mm, height 12 mm, depth 220 mm. Weight 1.71 kg.

Available in black colour.

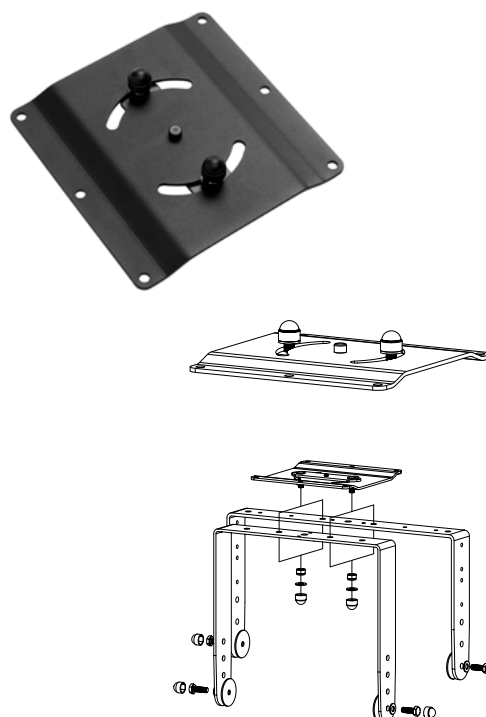

Compatible only when using S360-424 top-bottom and S360-450 side-side brackets:

S360

Wall and ceiling mount for 3440A subwoofer

3440-400B Wall and Ceiling Mount

The wall and ceiling mount for the 3440A Smart IP Active Subwoofer is slim, sturdy, and easy to install. The mount consists of two metal parts that slide together, enabling attachment of the subwoofer to a wall or ceiling. After attaching one side of the mount to the subwoofer, the subwoofer slides in place from the top or the side and is locked in place by screws. The mount has a fixing point for a safety wire (not included).

Width 349 mm, height 270,5 mm, depth 30 mm. Weight 3,3 kg.

Available in black colour.

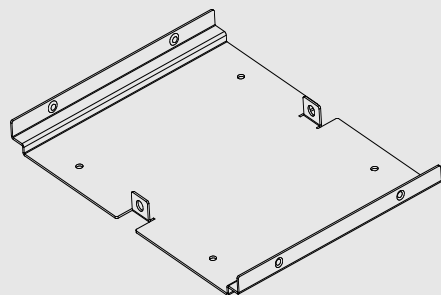

Compatible with models: 3440A

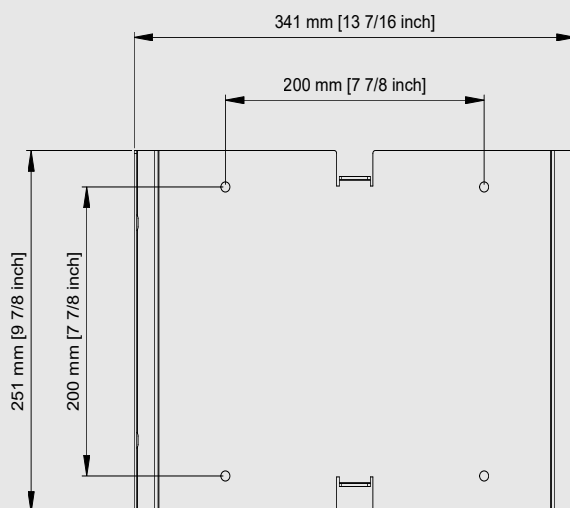



Wall mounts

GENELEC®

Simple wall bracket for XX20 and XX30

4000-410B Wall mount (simple bracket), black

4000-410W Wall mount (simple bracket), white

Simple bracket for mounting a wide range of Genelec loudspeakers onto the wall (check compatibility below). Included as standard with 4020, 4420, 4030 and 4430.

Width 90 mm, height 46 mm, depth 30 mm. Weight 0,1 kg.

Available in black and white colours.

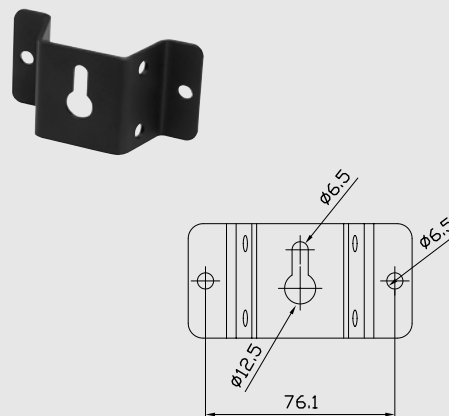

Compatible with models: 8010, 8020, 8030, 8320, 8330
G One, G Two, G Three
4010, 4020, 4030, 4410, 4420, 4430

Simple wall bracket for XX40

4000-414B Wall mount bracket, black

4000-414W Wall mount bracket, white

A simple fixed wall mount bracket. Included as standard with each 4040 loudspeaker.

Width 122,9 mm, height 65,8 mm, depth 40 mm. Weight 0,277 kg.

Available in black and white colours.



Compatible with models: 8040, 8340, 8341
G Four
4040

Two-position wall bracket

8010-410B Wall mount bracket, black
8010-410W Wall mount bracket, white

Simple bracket for mounting 8010, G One, 4010 or 4410 onto wall.
 Loudspeaker can be installed straight or at a 30-degree tilt angle.
 Included as standard with 4010 and 4410.

Width 42 mm, height 40 mm, depth 85mm. Weight 0,09 kg.

Available in black and white colours.

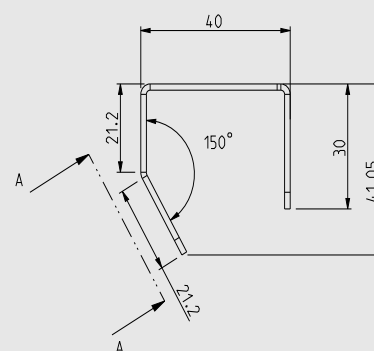

Compatible with models: 8010
 G One
 4010, 4410

Wall mount for S360, 8351 & 8361

S360-444B Wall mount for S360, 8351, 8361

Adjustable wall mount for S360, 8351, and 8361. Enables tilting and panning of the loudspeaker. Use with S360 requires S360-424B Top-Bottom Bracket.

Width 142 mm, height 220 mm, depth 106,5 mm. Weight 1.75 kg.

Available in black colour.

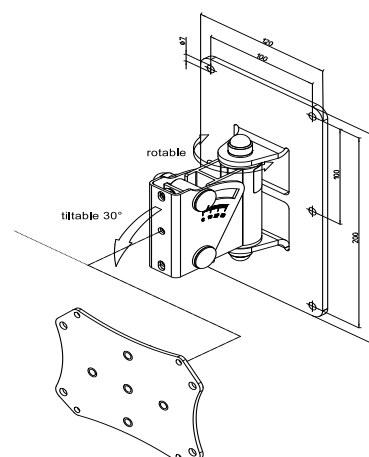

Compatible with models: 8351, 8361

Compatible only when using S360-424 Top-Bottom and S360-450 Side-Side Brackets: S360

Short ball-joint wall mount

8000-420CB Short wall mount, black
8000-420CW Short wall mount, white

Wall mount with ball-joint for a wide range of Genelec loudspeakers (check compatibility below). Enables 360-degree rotation of the loudspeaker and a maximum of 90 degrees tilt, depending on the model and placement.

Width 90 mm, height 89 mm, depth 62mm. Weight 0.37 kg.

Available in black and white colours.

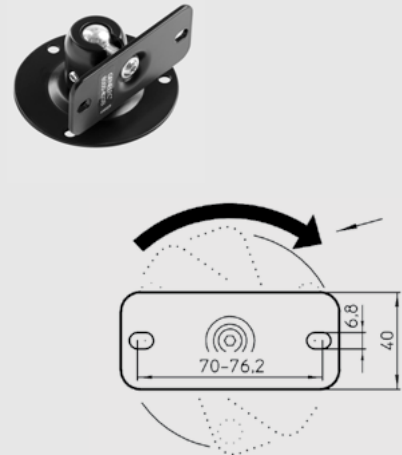

Compatible with models: 8010, 8020, 8320
G One, G Two
4010, 4020, 4410, 4420

Simple adjustable wall mount

8000-422B Wall mount with T-plate, black
8000-422W Wall mount with T-plate, white

Wall mount with basic vertical and horizontal tilting functions, for a wide range of Genelec loudspeakers (check compatibility below). Discreetly mount the loudspeaker on a wall and make basic adjustments to its vertical and horizontal aim, depending on the model and placement.

Width 100,31 mm, height 115 mm, depth 60mm. Weight 0.47 kg.

Available in black and white colours.

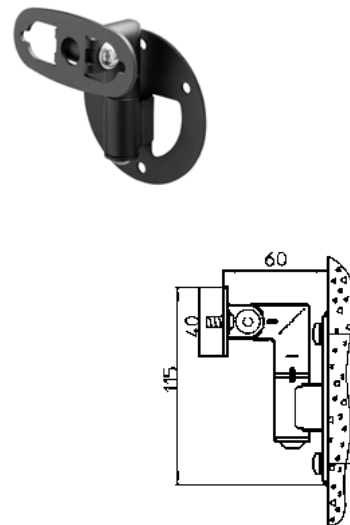

Compatible with models: 8010, 8020, 8320, 8030, 8330
G One, G Two, G Three
4010, 4020, 4030, 4410, 4420, 4430

Advanced adjustable wall mount

8000-402B Wall mounting bracket, black
8000-402W Wall mounting bracket, white

Extra sturdy wall mount with basic vertical and horizontal tilting functions, for a wide range of Genelec loudspeakers (check compatibility below). Conveniently mount the loudspeaker on a wall and set its vertical and horizontal aim. Includes T-adapter 8000-454B. Intended for use with XX3X, XX4X, XX5X, G Three, G Four, and G Five models.

Width 90 mm, height 160 mm, depths 104 (129) mm. Weight 1.05 kg.

Available in black and white colours.

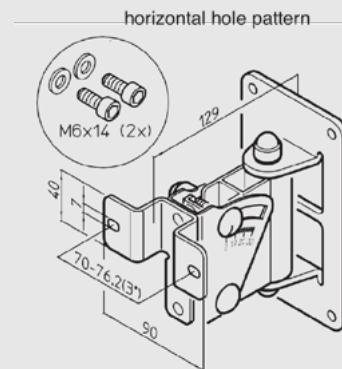

Intended for models: 8030, 8040, 8330, 8340, 8331, 8341, 8050, 8350, 8351
 G Three, G Four, G Five
 4030, 4040, 4430

Also compatible with models: 8010, 8020, 8320
 G One, G Two
 4010, 4020, 4410, 4420

VESA adapter

8000-437B VESA adapter 75/100 mm

Simple and sturdy adapter ensuring compatibility between Genelec loudspeakers and VESA 75/100 accessories. Easily install Genelec loudspeakers with a VESA standard mechanical mounting system.

Width 111 mm, height 12 mm, depth 111 mm. Weight 0.18 kg.

Available in black colour.

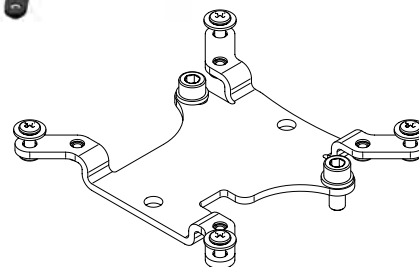

Compatible with models: 8000 Series, 8300 Series (excluding 8361)
 G Series
 4000 and 4400 Series (excluding 4435/36)



Other accessories

GENELEC®

Grille for 1032

1032-409 Grille for 1032A

Acoustically transparent fabric grille. Mounts with integrated plastic studs.

Width 320 mm, height 495 mm, depth 12 mm. Weight 0,35 kg.

Available in black.

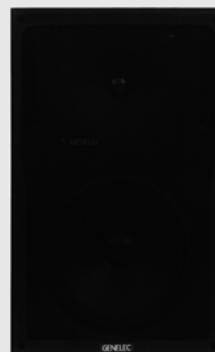

Compatible with models: 1032

Grille for 1237

1037-409 Grille for 1237

Acoustically transparent fabric grille. Mounts with integrated plastic studs.

Width 398 mm, height 678 mm, depth 12 mm. Weight 0,6 kg.

Available in black.



Compatible with models: 1237

Grille for 1238DF

1238-409 Grille for 1238DF

Acoustically transparent fabric grille. Mounts with integrated plastic studs.

Width 488 mm, height 608 mm, depth 12 mm. Weight 0,8 kg.

Available in black.



Compatible with models: 1238DF

4435/6 Grille round

4435/6 - MR Magnetically attaching round grille for Smart IP 4435A and 4436A loudspeakers, black

4435/6 - WR Magnetically attaching round grille for Smart IP 4435A and 4436A loudspeakers, white

Magnetically attaching round grille for Smart IP 4435A and 4436A loudspeakers, including magnetically attached Genelec logo.

Ø 288 mm. Weight 0,23 kg.

Available in black and white colours.

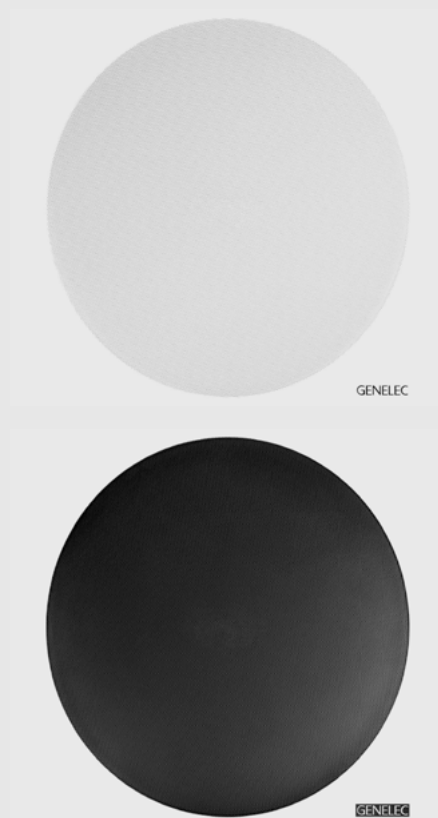

Compatible with models: 4435, 4436

4435/6 Grille square

4435 - MS Magnetically attaching square grille for Smart IP 4435A loudspeaker, black

Magnetically attaching square grille for Smart IP 4435A loudspeaker with magnetically attached Genelec logo.

Width 288 mm, height 288 mm. Weight 0,3 kg.

Available in black and white colours.

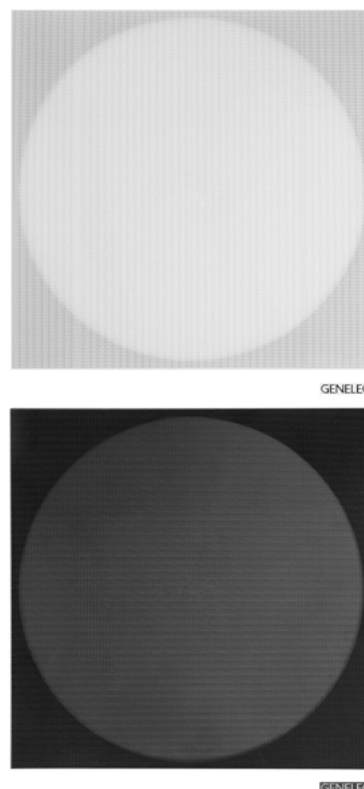

Compatible with models: 4435

Flush Mount Kit for XX4X and G Four

8341-450B Flush mount kit for XX4X, black

Flush Mount Kit for one speaker. The Genelec Flush Mount Kit allows you to mount the loudspeaker into a sturdy wall structure without changing its acoustic performance. The kit may not be used for any other purpose. Can be used for horizontal mounting also.

Width 310 mm, height 460 mm, depth 250 mm. Weight 9,5 kg.

Available in black colour.

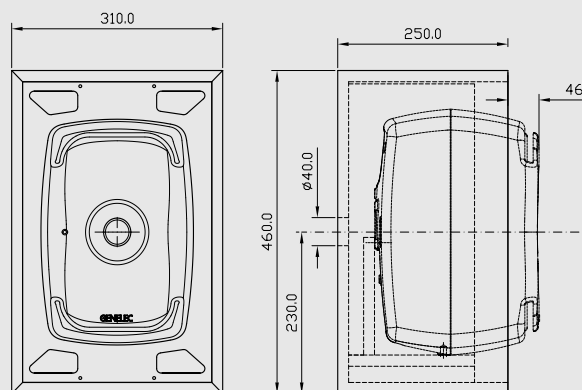
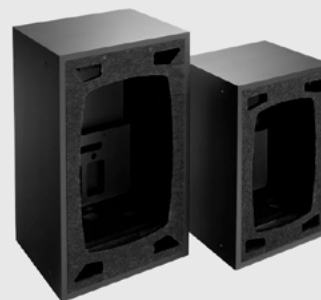

Compatible with models: 8040, 8340, 8341
G Four
4040

Flush Mount Kit for 8X5X and G Five

8351-450B Flush mount kit for XX5X, black

Flush Mount Kit for one loudspeaker. The Genelec Flush Mount Kit allows you to mount the loudspeaker into a sturdy wall structure without changing its acoustic performance. The kit may not be used for any other purpose. Can be used for horizontal mounting also.

Width 360 mm, height 575 mm, depth 286 mm. Weight 13,6 kg.

Available in black colour.

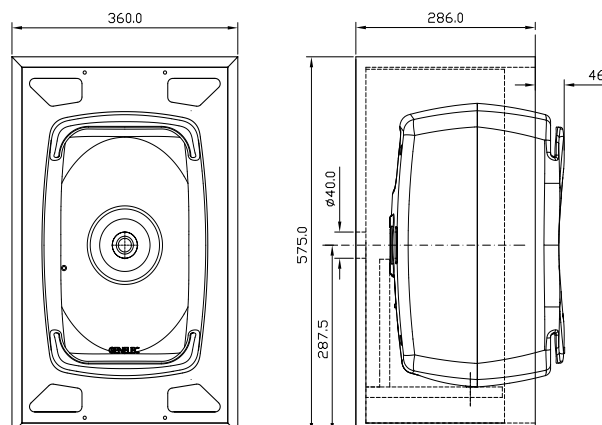

Compatible with models: 8050, 8350, 8351
G Five

Side-Side bracket for S360

S360-450B Side-Side bracket for S360

Multipurpose mounting bracket for S360. Can be used as a stand-alone mount, with truss clamps, with S360-415B Design Floorstand or with S360-465B Ceiling Mount Plate. Supplied with M10 mounting bolts and washers.

Width 60 mm, height 375 mm, depth 292 mm. Weight 2.56 kg.

Available in black colour.



Compatible with models: S360

Top-Bottom bracket for S360

S360-424B Top-Bottom Bracket for S360

Multipurpose mounting bracket for S360. Can be used as a stand-alone mount, with truss clamps, with 8000-442B and 8000-444B Ceiling Mounts, S360-465B Ceiling Mount Plate, and S360-444B Wall Mount. Supplied with M10 mounting bolts and washers.

Width 60 mm, height 514 mm, depth 292 mm. Weight 3.04 kg.

Available in black colour.



Compatible with models: S360

Installation friendly signal cable

1510-888 Installation cable

Signal cable with shielded pair for balanced line-level analogue audio. Slimline white plastic jacket. 100 m reel.





Carrying accessories

GENELEC®

Carrying strap

8000-430 Carrying strap black

Nylon carrying strap for a wide range of Genelec loudspeaker models (check compatibility below). Mounts with included M6 screws onto the back of the loudspeaker.

Width 335 mm, height 10 mm, depth 40 mm.

Available in black colour.

Compatible with models: 8000 Series, 8300 Series, The Ones Series
G Series
4000 Series, 4400 Series



Hard case 31

8000-831 Empty case for two pcs 8X30/8331

Sturdy case for easy travelling. Fits two loudspeakers plus accessories (check compatibility below). Features rubber handles, rugged extendable handle and four strong polyurethane wheels for extra comfort when carrying. Foam insert is custom-made in Finland to ensure the perfect fit and best possible protection for loudspeakers. All Peli Cases include a limited life-time warranty.

Width 467 mm, height 828 mm, depth 280 mm.

Available in black colour.

Compatible with models: 8030, 8330, 8331
G Three
4030, 4430



Hard case 41

8000-841 Empty case for two pcs 8X40/8341

Sturdy case for easy travelling. Fits two loudspeakers plus accessories (check compatibility below). Features rubber handles, rugged extendable handle and four strong polyurethane wheels for extra comfort when carrying. Foam insert is custom-made in Finland to ensure the perfect fit and best possible protection for loudspeakers. All Peli Cases include a limited life-time warranty.

Width 518 mm, height 795 mm, depth 394 mm.

Available in black colour.

Compatible with models: 8040, 8340, 8341
G Four
4040



Hard case 51

8000-851 Empty case for one pc 8X50/8351

Sturdy case for easy travelling. Fits one loudspeaker plus accessories (check compatibility below). Features rubber handles, rugged extendable handle and four strong polyurethane wheels for extra comfort when carrying. Foam insert is custom-made in Finland to ensure the perfect fit and best possible protection for loudspeakers. All Peli Cases include a limited life-time warranty.

Width 502 mm, height 640 mm, depth 375 mm.

Available in black colour.



Compatible with models: 8050, 8350, 8351
G Five

Soft carrying bag for two pcs 8010

8010-424 Carrying bag for two pcs 8010

Soft transportation bag for two Genelec loudspeakers (check compatibility below). Easily transport and protect loudspeakers. Made of durable, lightweight material. Convenient front pockets for smaller accessories. Padded divider separates loudspeakers inside the bag. Includes adjustable and removable shoulder strap.

Width 250 mm, height 240 mm, depth 130 mm.

Available in black colour.



Compatible with models: 8010
G One
4010, 4410

Soft carrying bag for two pcs 8020

8020-423 Carrying bag for two pcs 8020

Soft transportation bag for two Genelec loudspeakers (check compatibility below). Easily transport and protect loudspeakers. Made of durable, lightweight material. Features carry handles and convenient front pockets for smaller accessories. Padded divider separates loudspeakers inside the bag. Includes adjustable and removable shoulder strap.

Width 290 mm, height 280 mm, depth 165 mm.

Available in black colour.



Compatible with models: 8020, 8320
G Two
4020, 4420

Soft carrying bag for two pcs 8030

8030-423 Carrying bag for two pcs black 8030

Soft transportation bag for two Genelec loudspeakers (check compatibility below). Easily transport and protect loudspeakers. Made of durable, lightweight material. Features carry handles and convenient front pockets for smaller accessories. Padded divider separates loudspeakers inside the bag.

Width 360 mm, height 320 mm, depth 190 mm.

Available in black colour.



Compatible with models: 8030, 8330
G Three
4030, 4430

Soft carrying bag for two pcs 8040

8040-423 Carrying bag for two pcs 8040

Soft transportation bag for two Genelec loudspeakers (check compatibility below). Easily transport and protect loudspeakers. Made of durable, lightweight material. Features carry handles and convenient front pockets for smaller accessories. Padded divider separates loudspeakers inside the bag.

Width 450 mm, height 380 mm, depth 230 mm.

Available in black colour.



Compatible with models: 8040, 8340, 8430
G Four
4040

Soft carrying bag for one pc 8050

8050-423 Carrying bag for one pc black 8050

Soft transportation bag for one Genelec loudspeaker (check compatibility below). Easily transport and protect the loudspeaker. Made of durable, lightweight material. Features carry handles and convenient front pockets for smaller accessories.

Width 460 mm, height 280 mm, depth 280 mm.

Available in black colour.



Compatible with models: 8050, 8350, 8351
G Five

GENELEC®

Detailed product descriptions, quick installation guides and other useful information for all Genelec models can be downloaded from www.genelec.com. Genelec Document BBAGE251. Copyright Genelec Ltd 12/2025. All rights reserved.